

Retail Space Available - Join CVS & Shops
Located between Harris Teeter & Walmart Neighborhood Market
College Road @ Hunt Club Road, Greensboro NC



Retail Space Available: 1,200 to 4,230 Sq. Ft. Available in units of 1,200, 1,540, 1,830 or 2,400 Sq. Ft.

Area Generators: CVS, Harris Teeter, Chick-Fila-A, Walmart Neighborhood Market, Guilford College, Hardee's, McDonald's, Bank of America, BB&T, Starbucks, Pizza Hut, Goodyear Tire, Guilford Middle School, Suburban Offices, others.

Co-Tenancy: CVS, H&R Block, \$2.50 Cleaners, Home Slice Pizza & Subs, Amoroso's Bakery, La Bella Looks.

| | | | | |
|---|-----------------------|----------------------|----------------------|----------------------|
| Demographic Profile: (2019 Est) | | <u>1 Mile</u> | <u>3 Mile</u> | <u>5 Mile</u> |
| | Population: | 8,789 | 58,166 | 161,008 |
| | Avg HH Income: | \$75,501 | \$80,363 | \$79,453 |
| | Employment: | \$3,189 | \$44,933 | \$121,295 |

| | | |
|------------------------|-------------------------|------------|
| Traffic Counts: | College Rd: | 19,000 VPD |
| | Hunt Club Rd: | 4,800 VPD |
| | W. Friendly Ave: | 30,000 VPD |

Lease Rate: \$15.00 to \$16.00 PSF plus \$4.00 PSF TICAM

| | | |
|---|--|---|
| <p>RAYMOND D. COLLINS, JR., CCIM OFC: (336) 768-0555 MOBILE: (336) 978-6444 EM: ray@collinscommprop.com WEBSITE: www.collinscommprop.com</p> | | <p>COLLINS COMMERCIAL PROPERTIES, INC. 2990 Bethesda Place, Suite 601C Winston-Salem, NC 27103</p> |
|---|--|---|

No Warranties or representations, expressed or implied, are made as to the accuracy of the information contained herein or hereafter provided, and same is provided subject to errors, omissions, change of price, rental or other conditions and withdrawal without notice. This information is given with the understanding that all negotiations relating to the leasing or sale of the property described herein shall be conducted through Collins Commercial Properties, Inc., Winston-Salem, North Carolina.

COLLINS
COMMERCIAL
PROPERTIES, INC.

W. Friendly Ave.

Starbucks
T-Mobile
Elizabeth's Pizza
Anytime Fitness
Walmart Neighborhood Market

BB&T

Guilford
COLLEGE

McDonald's

Pizza Hut



N. College Rd.
(19,000 VPDF)

Hardee's

GOODYEAR

Chick-fil-A

Harris Teeter
Your Neighborhood Food Store

CVS @ College Square
H&R Block,
\$2.50 Cleaners,
Home Slice Pizza & Subs,
Amoroso's Bakery,
La Bella Looks

W. Guilford Middle
School

All Suite Addresses: 5803 Hunt Club Road

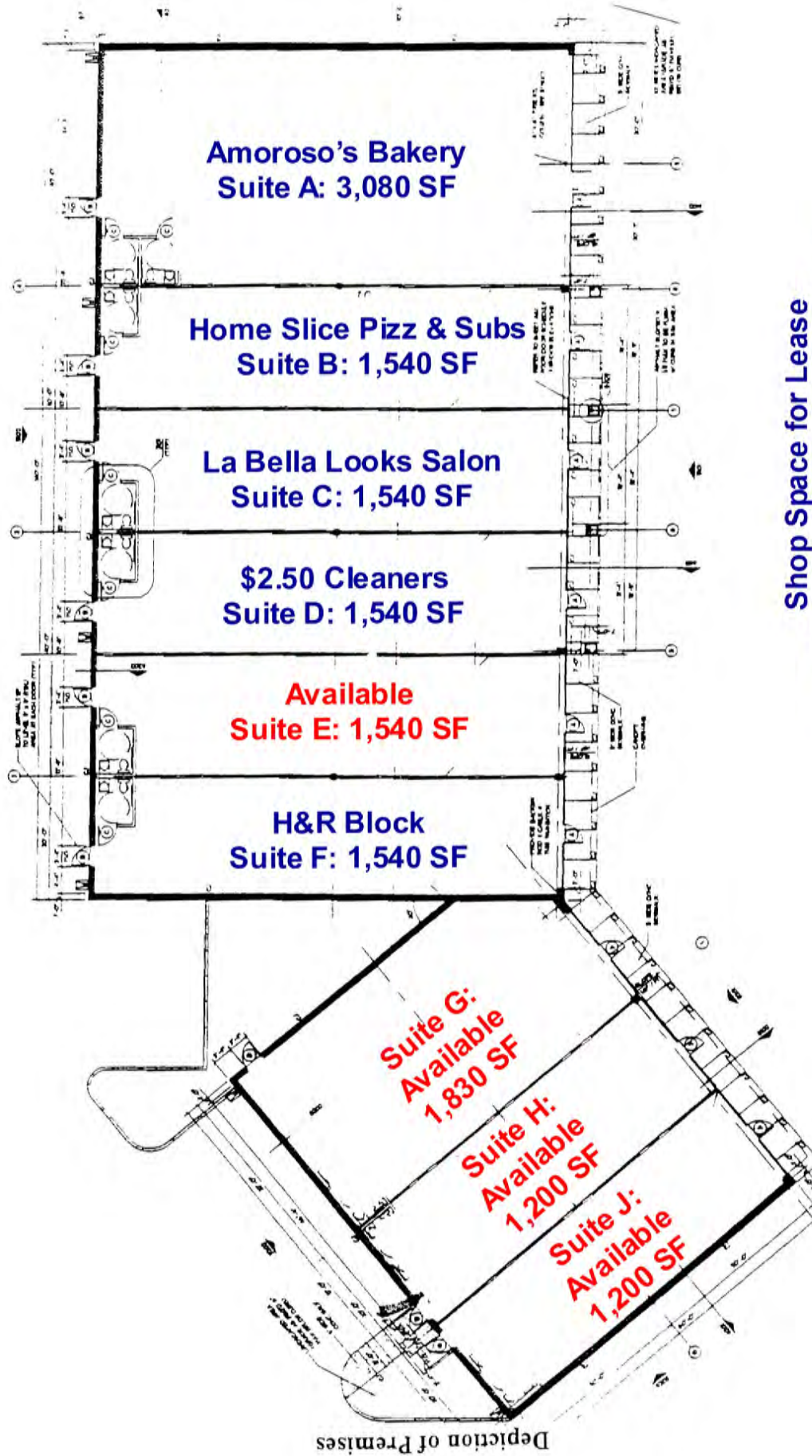

Depiction of Premises

Schedule F

Shop Space for Lease
CVS Shops @ College Square
609 College Rd. @ Hunt Club Rd.,
Greensboro NC

RAYMOND D. COLLINS, JR., CCIM
OFC: (336) 768-0555
FAX: (336) 768-2055
EM: ray@collinscommprop.com
WEBSITE: www.collinscommprop.com

