

**Retail Space Available - Join CVS & Shops**  
**Located between Harris Teeter & Walmart Neighborhood Market**  
**College Road @ Hunt Club Road, Greensboro NC**



**Retail Space Available:** 1,200 to 3,030 Sq. Ft. Available in units of 1,200, 1,540, or 1,830 Sq. Ft.

**Area Generators:** CVS, Harris Teeter, Chick-Fila-A, Walmart Neighborhood Market, Guilford College, Hardee's, McDonald's, Bank of America, BB&T, Starbucks, Pizza Hut, Goodyear Tire, Guilford Middle School, Suburban Offices, others.

**Co-Tenancy:** CVS, H&R Block, \$2.50 Cleaners, Home Slice Pizza & Subs, Amoroso's Bakery, La Bella Looks, POW! Nutrition, Kiwi Clubhouse

<b>Demographic Profile:</b> (2019 Est)		<u><b>1 Mile</b></u>	<u><b>3 Mile</b></u>	<u><b>5 Mile</b></u>
	<b>Population:</b>	8,789	58,166	161,008
	<b>Avg HH Income:</b>	\$75,501	\$80,363	\$79,453
	<b>Employment:</b>	\$3,189	\$44,933	\$121,295

<b>Traffic Counts:</b>	<b>College Rd:</b>	19,000 VPD
	<b>Hunt Club Rd:</b>	4,800 VPD
	<b>W. Friendly Ave:</b>	30,000 VPD

**Lease Rate: \$15.00 PSF plus \$4.20 PSF TICAM**

<p><b>RAYMOND D. COLLINS, JR., CCIM</b>  <b>OFC: (336) 768-0555</b>  <b>MOBILE: (336) 978-6444</b>  <b>EM: ray@collinscommprop.com</b>  <b>WEBSITE: www.collinscommprop.com</b></p>		<p><b>COLLINS COMMERCIAL PROPERTIES, INC.</b>  <b>2990 Bethesda Place, Suite 601C</b>  <b>Winston-Salem, NC 27103</b></p>
---	--	---

No Warranties or representations, expressed or implied, are made as to the accuracy of the information contained herein or hereafter provided, and same is provided subject to errors, omissions, change of price, rental or other conditions and withdrawal without notice. This information is given with the understanding that all negotiations relating to the leasing or sale of the property described herein shall be conducted through Collins Commercial Properties, Inc., Winston-Salem, North Carolina.

**COLLINS**  
COMMERCIAL  
PROPERTIES, INC.

W. Friendly Ave.

Starbucks  
T-Mobile  
Elizabeth's Pizzeria  
Anytime Fitness  
Walmart Neighborhood Market

BB&T

Guilford COLLEGE



N. College Rd.  
(19,000 VPDF)



GOODYEAR



Harris Teeter  
Your Neighborhood Food Store

CVS @ College Square  
H&R Block,  
\$2.50 Cleaners,  
Home Slice Pizza & Subs,  
Amoroso's Bakery,  
La Bella Looks,  
Kiwi Clubhouse

W. Guilford Middle  
School

All Suite Addresses: 5803 Hunt Club Road

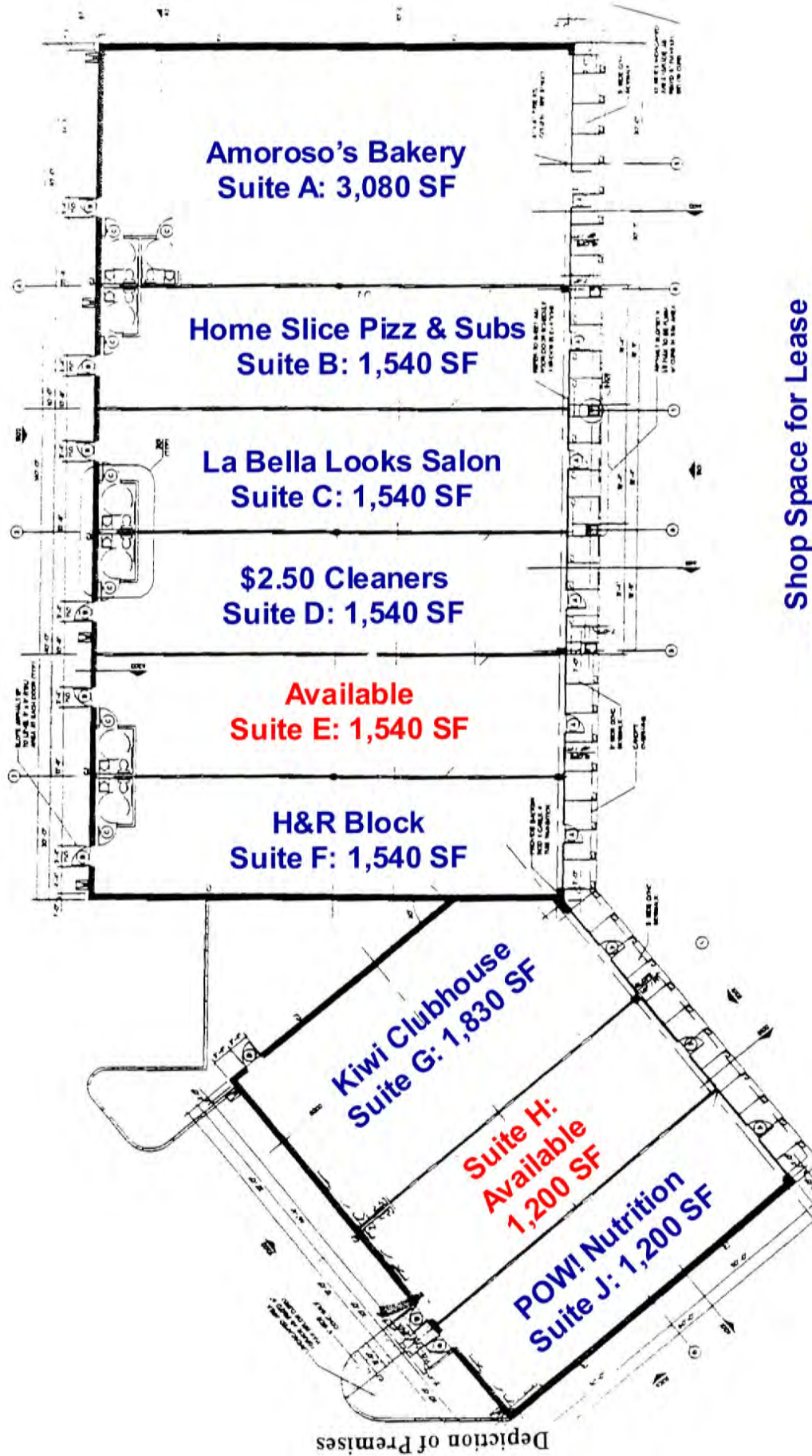

Depiction of Premises

Schedule F

Shop Space for Lease  
CVS Shops @ College Square  
609 College Rd. @ Hunt Club Rd.,  
Greensboro NC

RAYMOND D. COLLINS, JR., CCIM  
OFC: (336) 768-0555  
FAX: (336) 768-2055  
EM: ray@collinscommprop.com  
WEBSITE: www.collinscommprop.com

