

Retail Space Available - Join CVS & Shops

Located between Harris Teeter & Walmart Neighborhood Market

College Road @ Hunt Club Road, Greensboro NC



Retail Space Available: 1,200 to 4,230 Sq. Ft. Available in units of 1,200, 1,540, 1,830 or 2,400 Sq. Ft.

Area Generators: CVS, Harris Teeter, Chick-Fila-A, Walmart Neighborhood Market, Guilford College, Hardee's, McDonald's, Bank of America, BB&T, Starbucks, Pizza Hut, Goodyear Tire, Guilford Middle School, Suburban Offices, others.

Co-Tenancy: CVS, H&R Block, \$2.50 Cleaners, Home Slice Pizza & Subs, Amoroso's Bakery.

Demographic Profile: (2019 Est)		<u>1 Mile</u>	<u>3 Mile</u>	<u>5 Mile</u>
Population:		8,789	58,166	161,008
Avg HH Income:		\$75,501	\$80,363	\$79,453
Employment:		\$3,189	\$44,933	\$121,295

Traffic Counts:	College Rd:	19,000 VPD
	Hunt Club Rd:	4,800 VPD
	W. Friendly Ave:	30,000 VPD

Lease Rate: \$15.00 to \$16.00 PSF plus \$4.00 PSF TICAM

RAYMOND D. COLLINS, JR., CCIM
OFC: (336) 768-0555
MOBILE: (336) 978-6444
EM: ray@collinscommprop.com
WEBSITE: www.collinscommprop.com



**COLLINS
 COMMERCIAL
 PROPERTIES, INC.**
 2990 Bethesda Place, Suite 601C
 Winston-Salem, NC 27103

No Warranties or representations, expressed or implied, are made as to the accuracy of the information contained herein or hereafter provided, and same is provided subject to errors, omissions, change of price, rental or other conditions and withdrawal without notice. This information is given with the understanding that all negotiations relating to the leasing or sale of the property described herein shall be conducted through Collins Commercial Properties, Inc., Winston-Salem, North Carolina.

RAYMOND D. COLLINS, JR., CCIM
OFF: (336) 768-0555
FAX: (336) 768-2055
EMAIL: ray@collinscommprop.com
WEBSITE: www.collinscommprop.com

**Shop Space for Lease
CVS Shops @ College Square
609 College Rd. @ Hunt Club Rd.,
Greensboro NC**

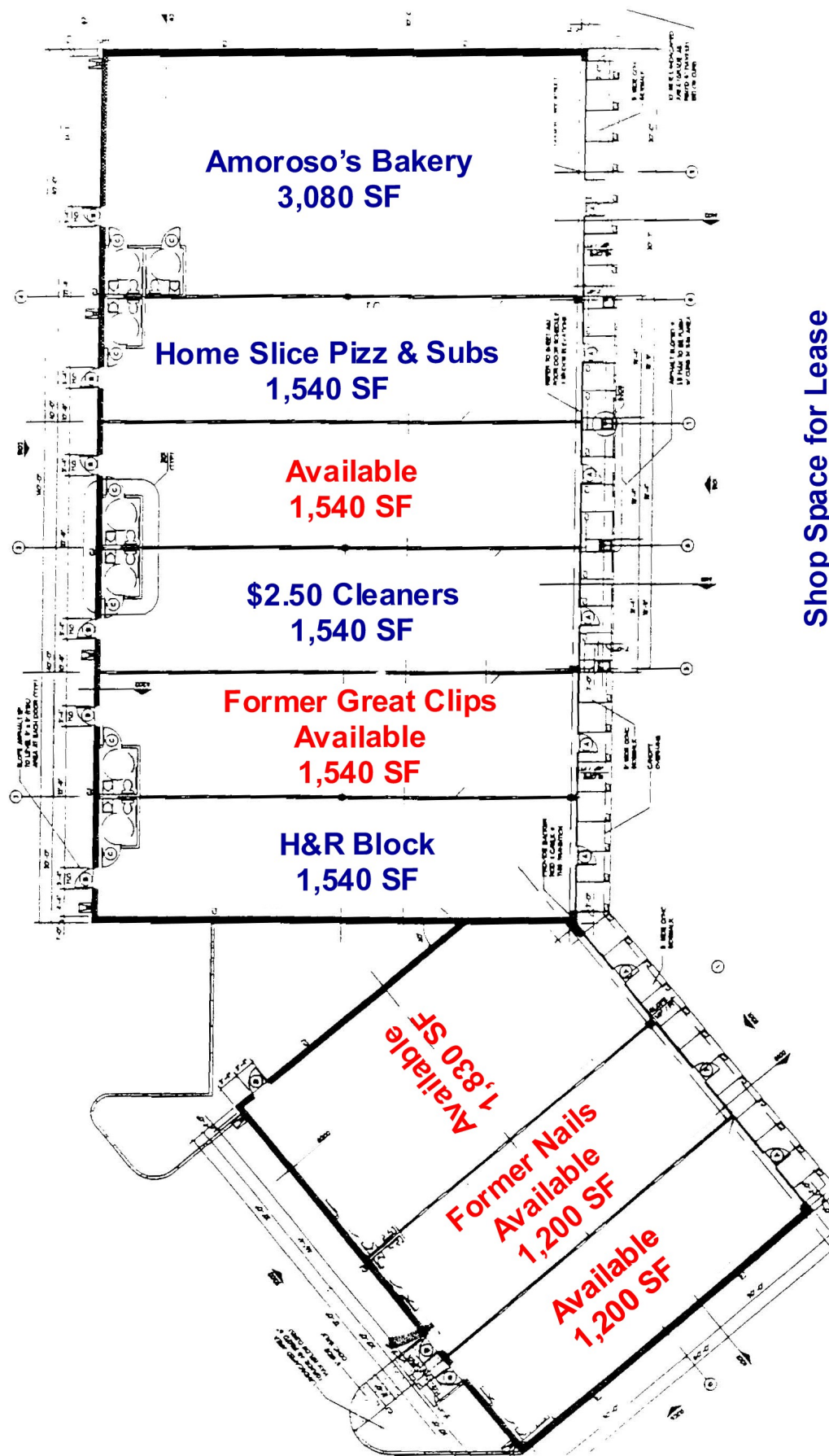



CVS @ College Square

H&R Block,
\$2.50 Cleaners,
Home Slice Pizza & Subs,
Amoroso's Bakery

W. Friendly Ave.



**N. College Rd.
(19,000 VPDF)**

**W. Guilford Middle
School**

COLLINS
COMMERCIAL
PROPERTIES, INC.